

PLAN OF C1520 MAGPIE RIVER TERRACES CONSERVATION RESERVE

GEOGRAPHIC TOWNSHIPS OF BAILLOQUET AND CHABANEL
NOW IN THE TOWNSHIP OF MICHIPICOTEN
DISTRICT OF ALGOMA

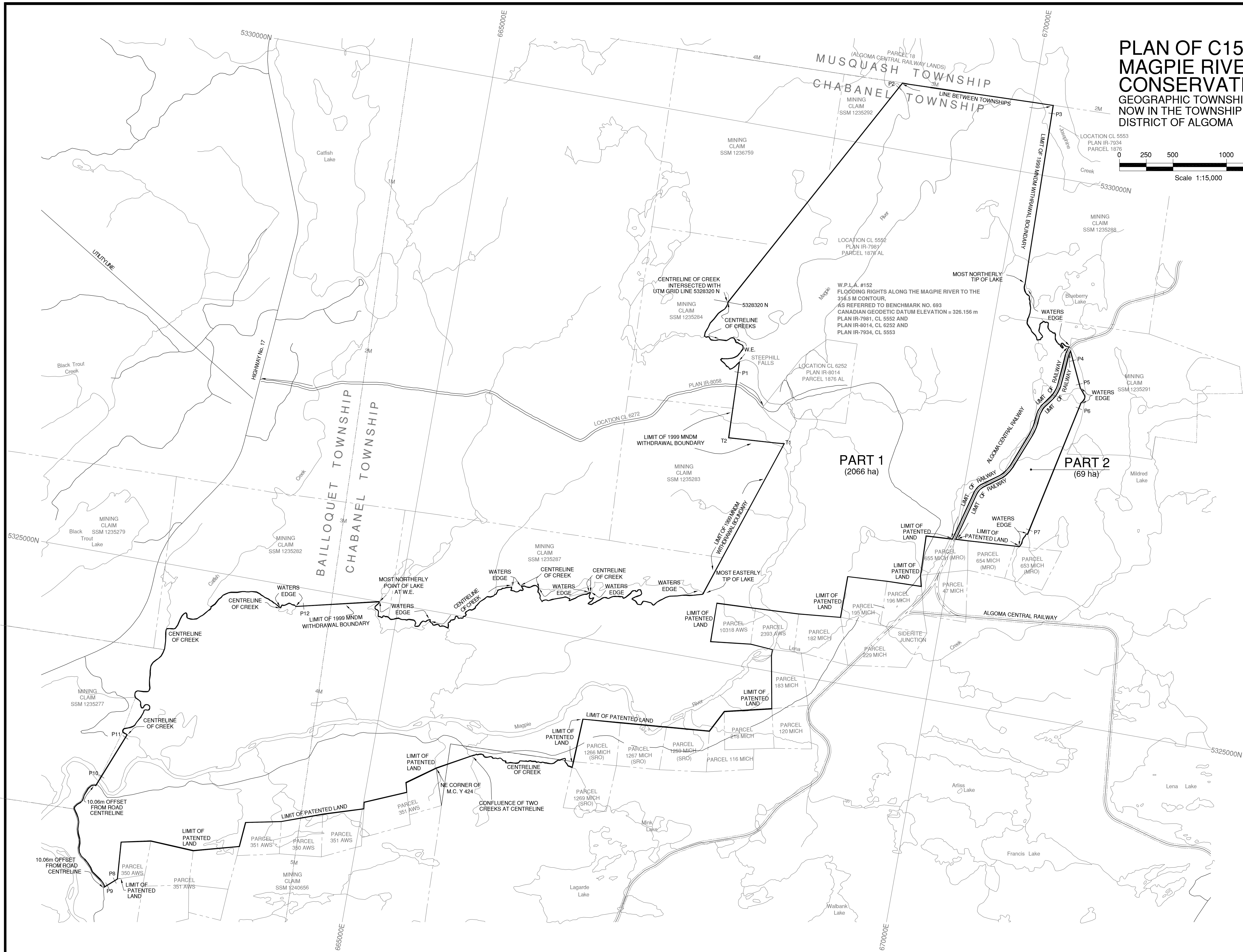
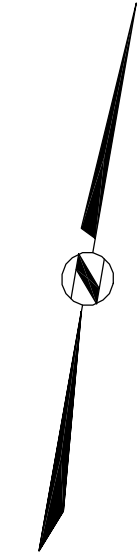
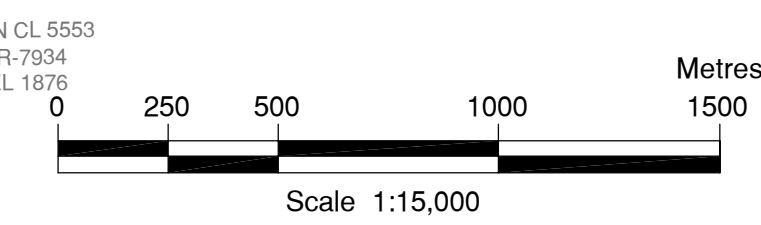

UTM COORDINATES OF INTERSECTION POINTS.		UTM COORDINATES OF POINTS ON THE BOUNDARY			
#	Eastings	Northings	#	Eastings	Northings
T1	668277	5327114	P1	667734	5327693
T2	667757	5327077	P2	668747	5330568
			P3	670194	5330583
			P4	670793	5328348
			P5	670889	5328142
			P6	670925	5327918
			P7	670669	5326721
			P8	662844	5322005
			P9	662781	5321948
			P10	662951	5322939
			P11	662708	5323337
			P12	664128	5324835

NOTES:

- CAUTION: THIS IS NOT A PLAN OF SURVEY.
- All coordinates are related to NAD83 CSRS(98)UTM Zone 16.
 - Points labelled "P" are to be used for the purpose of producing a boundary segment to an intersection.
 - Survey instructions from the Surveyor General must be obtained prior to establishing any of the boundaries on the ground.
 - All directions and distances shown hereon are grid.
 - AL - Algoma Leasehold.
 - MICH - Denotes Michipicoten.
 - AWS - Denotes Algoma West Section.
 - MNDM - Denotes Ministry of Northern Development and Mines.
 - MRO - Denotes Mining Rights Only.
 - SRO - Denotes Surface Rights Only.

AREA:	Part 1	2066 (ha)
	Part 2	69 (ha)
	Total	2135 (ha)

ONTARIO REGULATION No. _____
SCHEDULE No. _____

CERTIFICATE OF SURVEYOR GENERAL

I HEREBY CERTIFY THAT THIS PLAN HAS BEEN FILED WITH THE OFFICE OF THE SURVEYOR GENERAL OF ONTARIO IN THE MINISTRY OF NATURAL RESOURCES ON THE _____ DAY OF _____ 2001.

B. MALONEY
SURVEYOR GENERAL



DATE COMPLETED: December, 2001

This plan was compiled from data sets supplied by the Natural Resources and Values Information System (NRVIS), and other information of record in the Ministry of Natural Resources.
Produced by: Office of the Surveyor General