

# PLAN OF C1595 WAPUS CREEK CONSERVATION RESERVE

GEOGRAPHIC TOWNSHIPS OF LEONARD, LEITH,  
NORTH WILLIAMS AND RAY  
DISTRICT OF TIMISKAMING

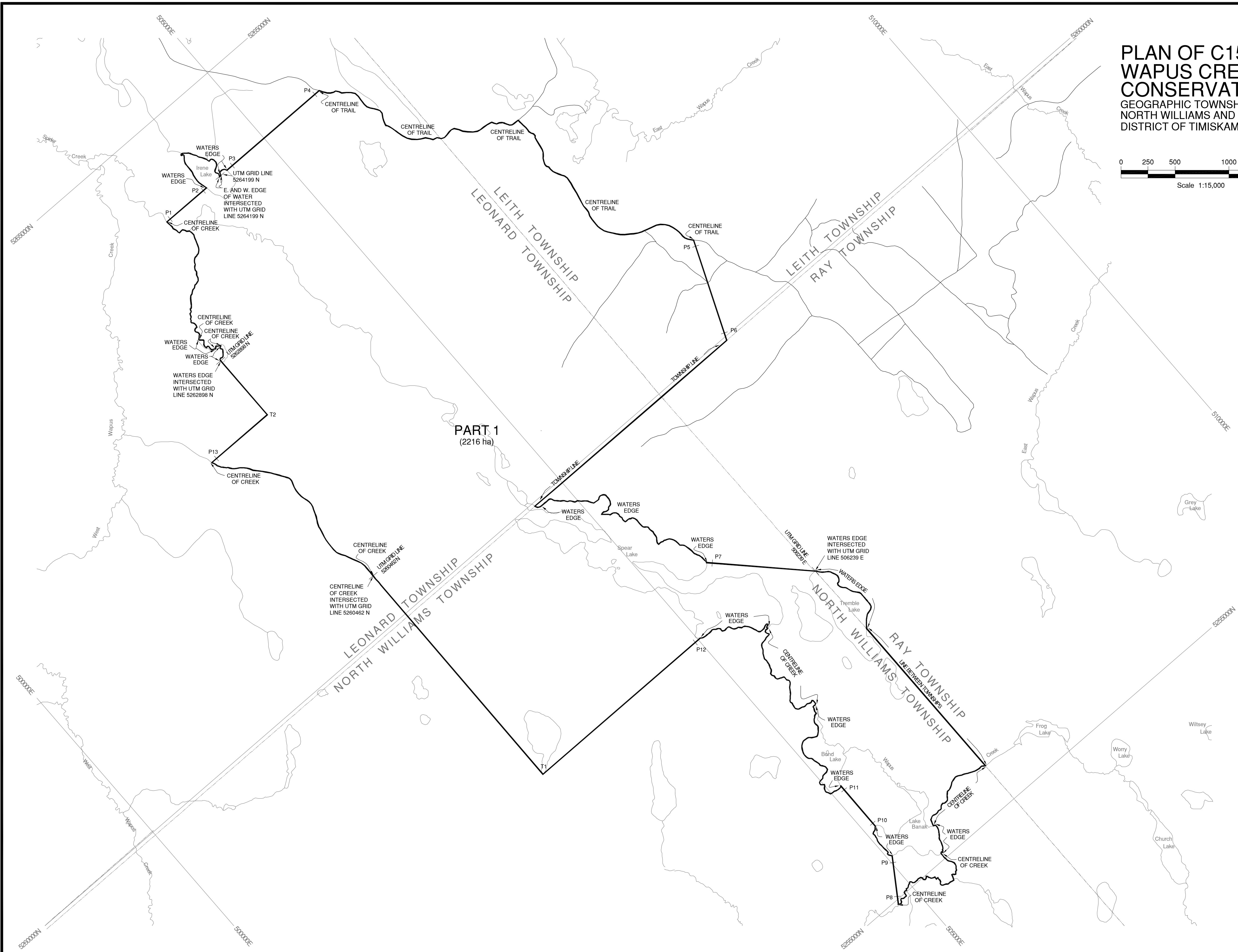
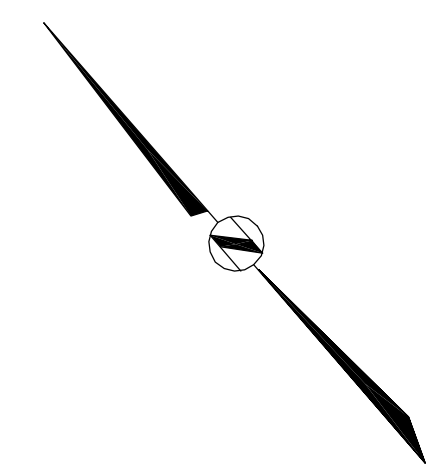
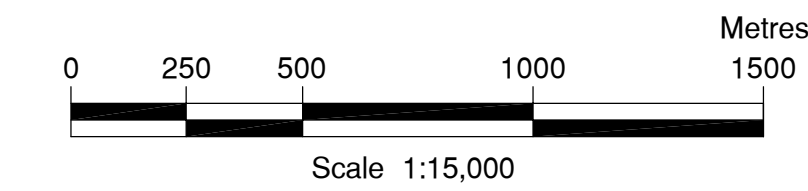

**PART 1**  
(2216 ha)

UTM COORDINATES OF INTERSECTION POINTS.		UTM COORDINATES OF POINTS ON THE BOUNDARY			
#	Eastings	Northings	# Eastings	Northings	
T1	503090	5258034	P1	503849	5264200
T2	503342	5262236	P2	504254	5264199
			P3	504612	5264198
			P4	505623	5264197
			P5	507374	5260816
			P6	507048	5260033
			P7	505564	5258489
			P8	504836	5255022
			P9	505011	5255287
			P10	505108	5255687
			P11	505110	5256094
			P12	504961	5258036
			P13	502718	5262237

**NOTES:**  
CAUTION: THIS IS NOT A PLAN OF SURVEY.

- All coordinates are related to NAD83 CSRS(98)/UTM Zone 17.
- Points labelled "P" are to be used for the purpose of producing a boundary segment to an intersection.
- Survey instructions from the Surveyor General must be obtained prior to establishing any of the boundaries on the ground.
- All directions and distances shown hereon are grid.

<b>AREA:</b>	Part 1 2216 (ha)
	Total 2216 (ha)

ONTARIO REGULATION No. \_\_\_\_\_  
SCHEDULE No. \_\_\_\_\_

**CERTIFICATE OF SURVEYOR GENERAL**

I HEREBY CERTIFY THAT THIS PLAN HAS BEEN FILED WITH THE OFFICE OF THE SURVEYOR GENERAL OF ONTARIO IN THE MINISTRY OF NATURAL RESOURCES ON THE \_\_\_\_\_ DAY OF \_\_\_\_\_ 2001.

B. MALONEY  
SURVEYOR GENERAL



DATE COMPLETED: ...July, 2001.....

This plan was compiled from data sets supplied by the Natural Resources and Values Information System (NRVIS), and other information of record in the Ministry of Natural Resources.

Produced by: Office of the Surveyor General