

**PLAN OF C1705
McGARRY TOWNSHIP FOREST
CONSERVATION RESERVE**
GEOGRAPHIC TOWNSHIP OF McFADDEN
AND IN THE GEOGRAPHIC TOWNSHIP OF McGARRY
IN THE MUNICIPAL TOWNSHIP OF McGARRY
DISTRICT OF TIMISKAMING

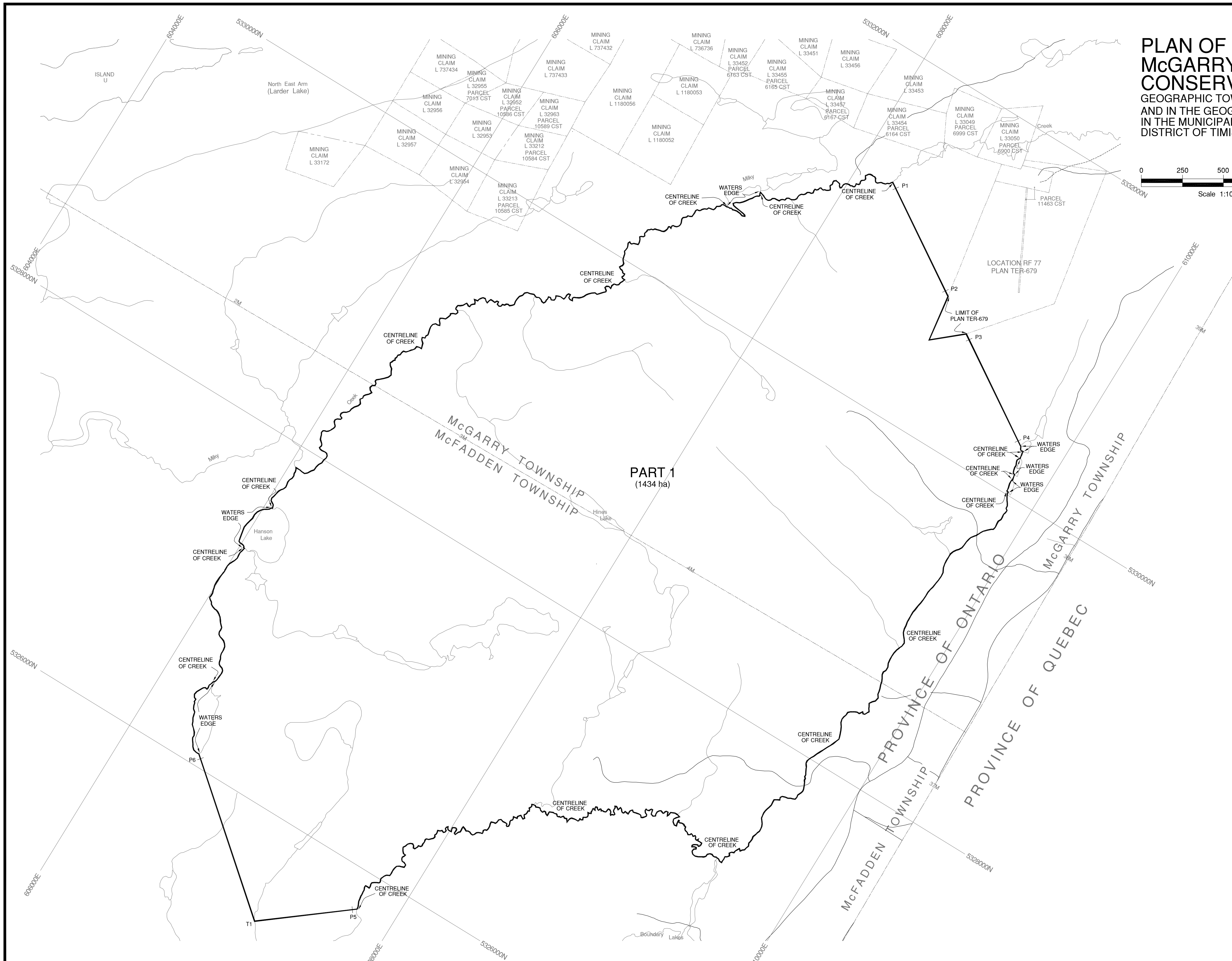
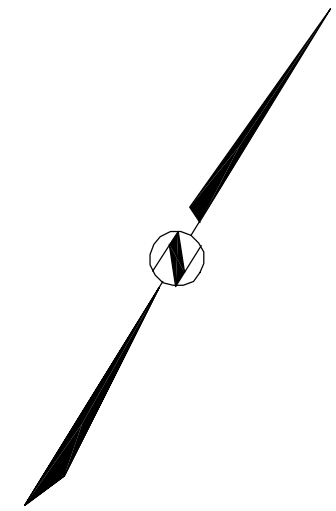
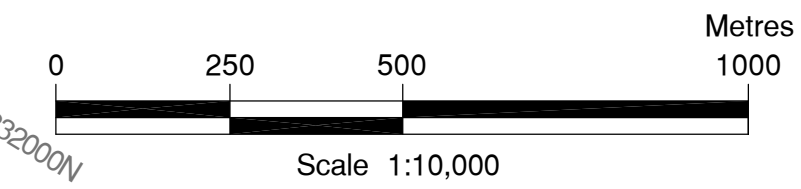

PART 1
(1434 ha)

UTM COORDINATES OF INTERSECTION POINTS.					
#	Easting	Northing	#	Easting	Northing
T1	607275	5325383	P1	608266	5331237
			P2	608851	5330863
			P3	609129	5330685
			P4	609707	5330315
			P5	607745	5325755
			P6	606475	5326053

NOTES:
CAUTION: THIS IS NOT A PLAN OF SURVEY.
1. All coordinates are related to NAD83 CSRS(98)UTM Zone 17.
2. Points labelled "P" are to be used for the purpose of producing a boundary segment to an intersection.
3. Survey instructions from the Surveyor General must be obtained prior to establishing any of the boundaries on the ground.
4. All directions and distances shown hereon are grid.
5. CST - Denotes Centre Section Timiskaming.

AREA:	Part 1	1434 (ha)
	Total	1434 (ha)

ONTARIO REGULATION No. _____
SCHEDULE No. _____

CERTIFICATE OF SURVEYOR GENERAL
I HEREBY CERTIFY THAT THIS PLAN HAS BEEN FILED WITH THE OFFICE OF THE SURVEYOR GENERAL OF ONTARIO IN THE MINISTRY OF NATURAL RESOURCES ON THE _____ DAY OF _____ 2001.
B. MALONEY
SURVEYOR GENERAL



DATE COMPLETED: ..August...2001.....
This plan was compiled from data sets supplied by the Natural Resources and Values Information System (NRVIS), and other information of record in the Ministry of Natural Resources.
Produced by: Office of the Surveyor General