

**PLAN OF
WAKAMI LAKE
PROVINCIAL PARK
(NATURE RESERVE CLASS)**
GEOGRAPHIC TOWNSHIPS OF WAKAMI, SYMINGTON,
NEELANDS, KELSEY AND BULLBROOK

DISTRICT OF SUDBURY

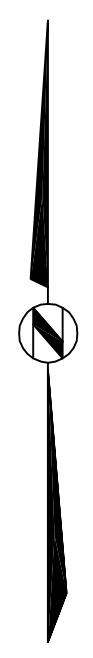
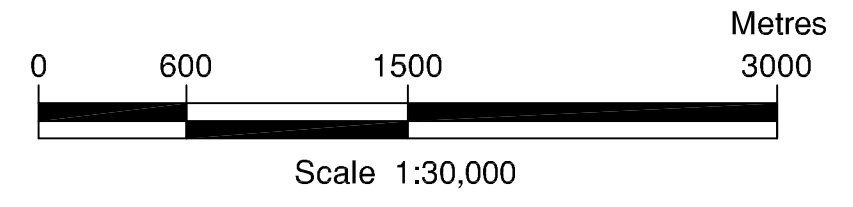
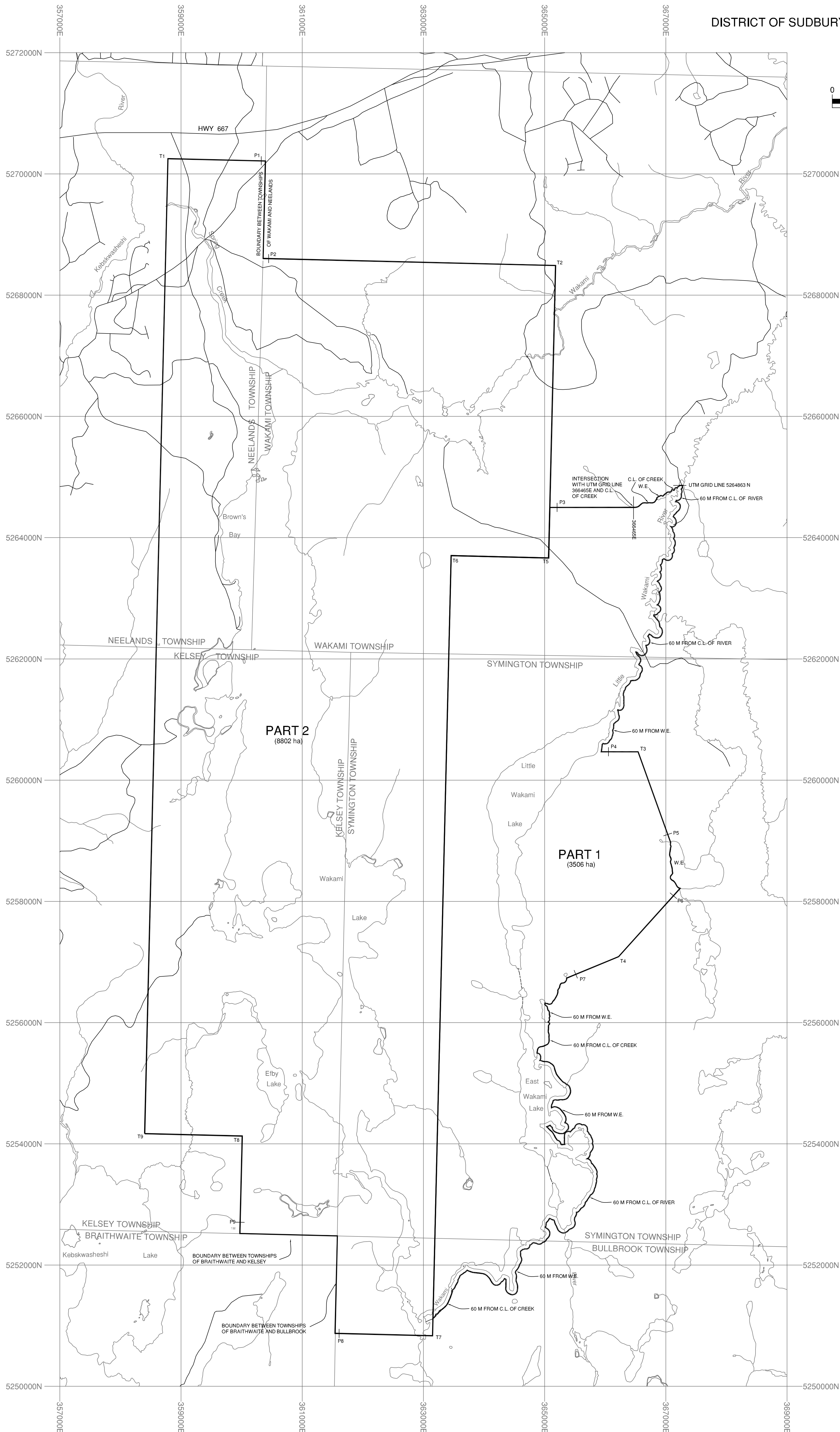

UTM COORDINATES OF INTERSECTION POINTS.			UTM COORDINATES OF POINTS ON THE BOUNDARY		
#	Easting	Northing	#	Easting	Northing
T1	358784	5270252	P1	360324	5270216
T2	365180	5268491	P2	360446	5268604
T3	366540	5260468	P3	365204	5264500
T4	366219	5257089	P4	366053	5260468
T5	364953	5263667	P5	367030	5259102
T6	363448	5263691	P6	367124	5258093
T7	363149	5250836	P7	365513	5256798
T8	360009	5254130	P8	361608	5250873
T9	358400	5254168	P9	359975	5252706

NOTES:
CAUTION: THIS IS NOT A PLAN OF SURVEY.
1. All coordinates are related to NAD83 CSRS(98)UTM Zone 17
2. Points labelled "P" are to be used for the purpose of producing a boundary segment to an intersection.
3. Survey instructions from the Surveyor General must be obtained prior to establishing any of the boundaries on the ground.
4. W.E. - Denotes Water's Edge.
5. P1640 - Is the recommended Provincial Park Addition: Ontario's Living Legacy, July 1999.

AREA :	Part 1	3506 (ha)	P1640
	Part 2	8802 (ha)	
	Total	12308 (ha)	

ONTARIO REGULATION No. _____
SCHEDULE No. _____

CERTIFICATE OF SURVEYOR GENERAL
I HEREBY CERTIFY THAT THIS PLAN HAS BEEN FILED WITH THE OFFICE OF THE SURVEYOR GENERAL OF ONTARIO IN THE MINISTRY OF NATURAL RESOURCES ON THE _____ DAY OF _____ 2003.

B. MALONEY
SURVEYOR GENERAL



DATE COMPLETED: ...November...2002.....

This plan was compiled from data sets supplied by the Natural Resources and Values Information System (NRVIS), and other information of record in the Ministry of Natural Resources and Northern Development and Mines.

Produced by: Office Of The Surveyor General