

# PLAN OF C106 ISLAND LAKE FOREST & BARRENS CONSERVATION RESERVE

GEOGRAPHIC TOWNSHIPS OF BROWN AND WILSON  
GEOGRAPHIC TOWNSHIPS OF BURTON AND MCKENZIE,  
NOW IN THE MUNICIPALITY OF WHITESTONE  
DISTRICT OF PARRY SOUND

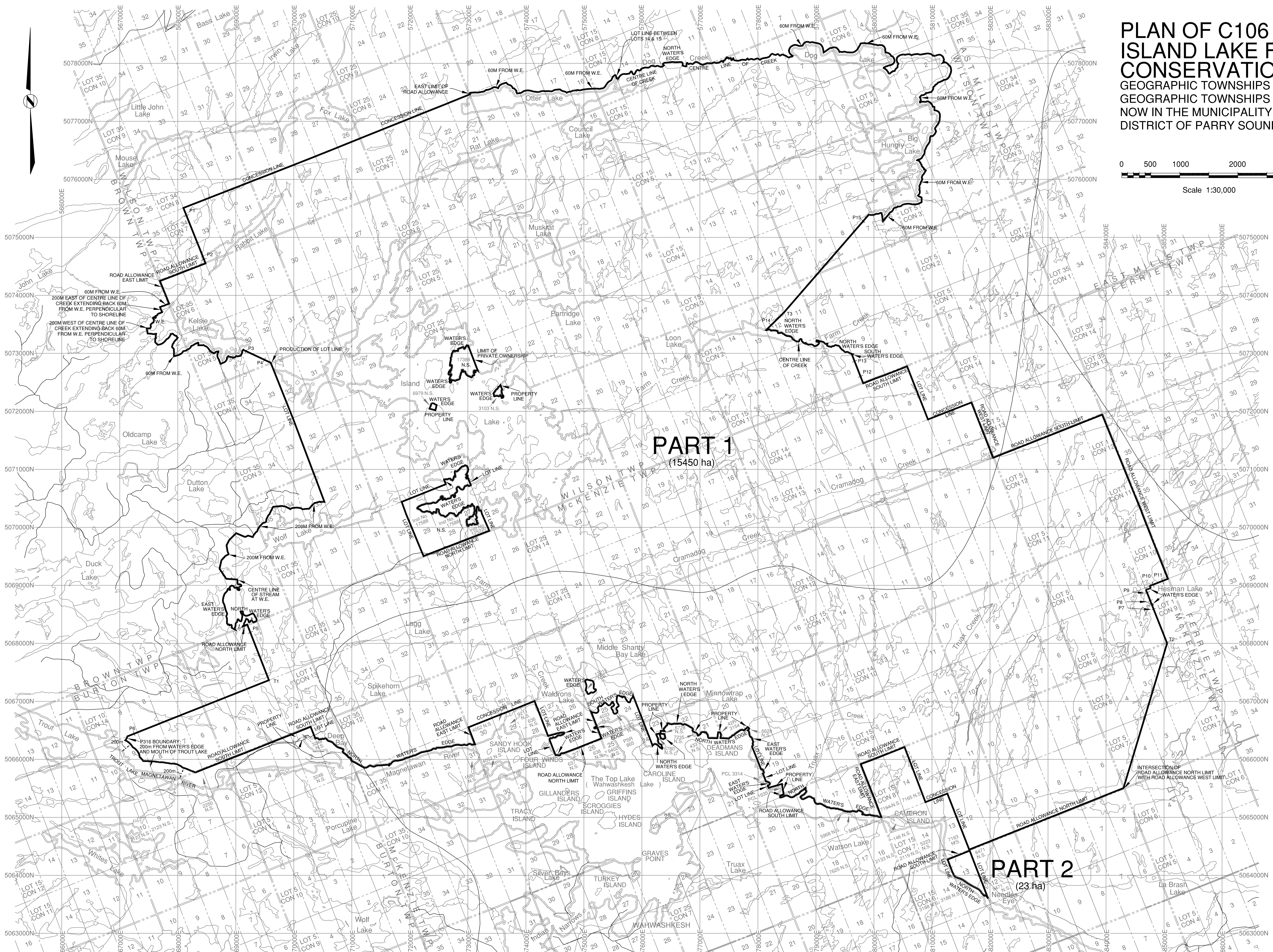
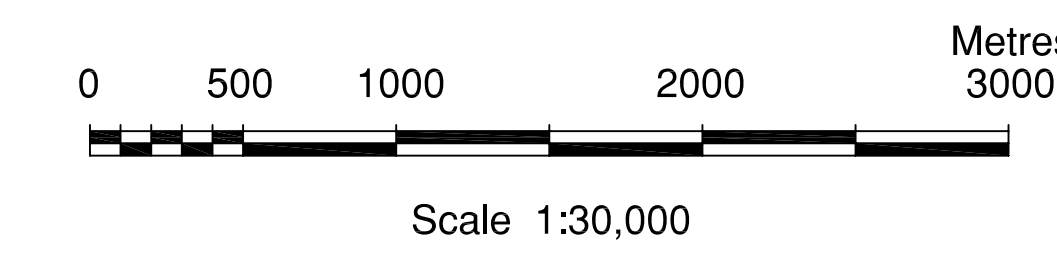

UTM COORDINATES OF POINTS ON THE BOUNDARY			UTM COORDINATES OF INTERSECTION POINTS.		
#	Eastings	Northing	#	Eastings	Northing
P1	568149	5075375	T1	569571	5067365
P2	568452	5074620	T2	585053	5068002
P3	569178	5073037	T3	578452	5073709
P4	569494	5072889			
P5	569250	5068188			
P6	567248	5066442			
P7	568419	5068592			
P8	584762	5068736			
P9	584707	5068874			
P10	584813	5069012			
P11	584973	5069076			
P12	579768	5072603			
P13	579665	5072864			
P14	578228	5073486			
P15	579815	5075280			

- NOTES:
- CAUTION: THIS IS NOT A PLAN OF SURVEY
  - All coordinates are related to NAD83 CSRS(98) Universal Transverse Mercator (6°) projection Zone 17 Central Meridian 81°W
  - Points labelled "P" are to be used for the purpose of producing a boundary segment to an intersection.
  - Survey instructions from the Surveyor General must be obtained prior to establishing any of the boundaries on the ground.
  - ALL DIRECTIONS AND DISTANCES SHOWN HEREON ARE GRID
  - All road allowances, between lots, between concessions, and along the shores of lakes, contained within the boundaries of this site, have been closed by O/C 2397/99, Dec. 15, 1999
  - W.E. - DENOTES WATER'S EDGE

AREA:	Part 1	15450 (ha)
	Part 2	23 (ha)
	<b>Total</b>	<b>15473 (ha)</b>

ONTARIO REGULATION No. \_\_\_\_\_  
SCHEDULE No. \_\_\_\_\_

**CERTIFICATE OF SURVEYOR GENERAL**

I HEREBY CERTIFY THAT THIS PLAN HAS BEEN FILED WITH THE OFFICE OF THE SURVEYOR GENERAL OF ONTARIO IN THE MINISTRY OF NATURAL RESOURCES ON THE \_\_\_\_\_ DAY OF \_\_\_\_\_ 2006.

B. MALONEY  
SURVEYOR GENERAL



DATE COMPLETED: .....January, 2006.....

This plan was compiled from data sets supplied by the Natural Resources and Values Information System (NRVIS), and other information of record in the Ministry of Natural Resources.

Produced by: Office Of The Surveyor General